

MEMORADUM

TO: All Returning Level Referees
FROM: **Peter Flook**
Ontario Lacrosse Association Administration –Referee Program
DATE: January 2012
RE: **Forms to be returned to Lacrosse office before clinic**

Here are the instructions on how to sign up for the referee clinic:

- 1) Send in all forms signed (make sure you sign all four pages on the 4 part form, yellow under 18 parent sign, blue 18 over you can sign) with money unless association is paying and sending in a cheque with someone the day of the clinic, then just send in the forms.
- 2) Get your forms in right away to hold your spot.
- 3) No fax, email, phone calls or scan forms will be accepted. We need original forms with pen signature.
- 4) Keep checking the website for location TBA to be confirmed or changed.

Waiting to the last minute or just showing up, you could be out of luck.

DATE	ZONE	CITY	LOCATION
March 24th	10	Brampton	Turner Fenton High School
March 25th	7	London	Kiwanis Seniors Community Centre
April 14th	1	Thunder Bay	St. Patrick Secondary School
April 14th	4	Sudbury	TBA
April 14th	6	Whitby	Henry Street High School
April 15th	8	Cambridge	<i>Jacob Hespeler S.S.</i>
April 21st	9	TBA	TBA
April 21st	5	Ottawa	St. Matthews High School
April 22nd	5	Akwesasne	Akwesasne Mohawk School
April 22nd	4	Orillia	Rotary Place

Cost of the Clinic is as Follows:

Entry Level (new)-\$155.00
Level 1 or Level 2 returning-\$110.00
Level 3-\$135.00

Deadline for returning referees to have **their forms and money into the office by Friday March 2nd. Do not postdated for Friday March 2nd.** If the association is paying get your forms in by this date.

See attached registration forms. Maps will be on the Ontario Lacrosse website by January 20th ready for the following week

Zone 5 Referees Clinic
Saturday April 21st, 2012
Level 1 to 3

<u>Date</u>	<u>Location</u>
Saturday, April 2 nd , 2011	St. Matthew Catholic High School
Registration 8:15am to 9:00am	6550 Bilberry Drive
Clinic: 9:00am to 4:00pm	Orleans, Ontario, K1C 2S9, Phone: 613-837-3161

Fees: \$110.00 for re-certifying 2011 Referees at level 1 & 2
 \$135.00 for Level 3 referees
 \$155.00 for all other referees

Required at Clinic: By all participants - pen & paper
 Referees - OLA referees binder & rule book.



Zone 8- Sunday April 15th, 2012

Jacob Hespeler S.S.
355 Holiday Inn Dr.
Cambridge, ON
Canada
N3C 1Z2

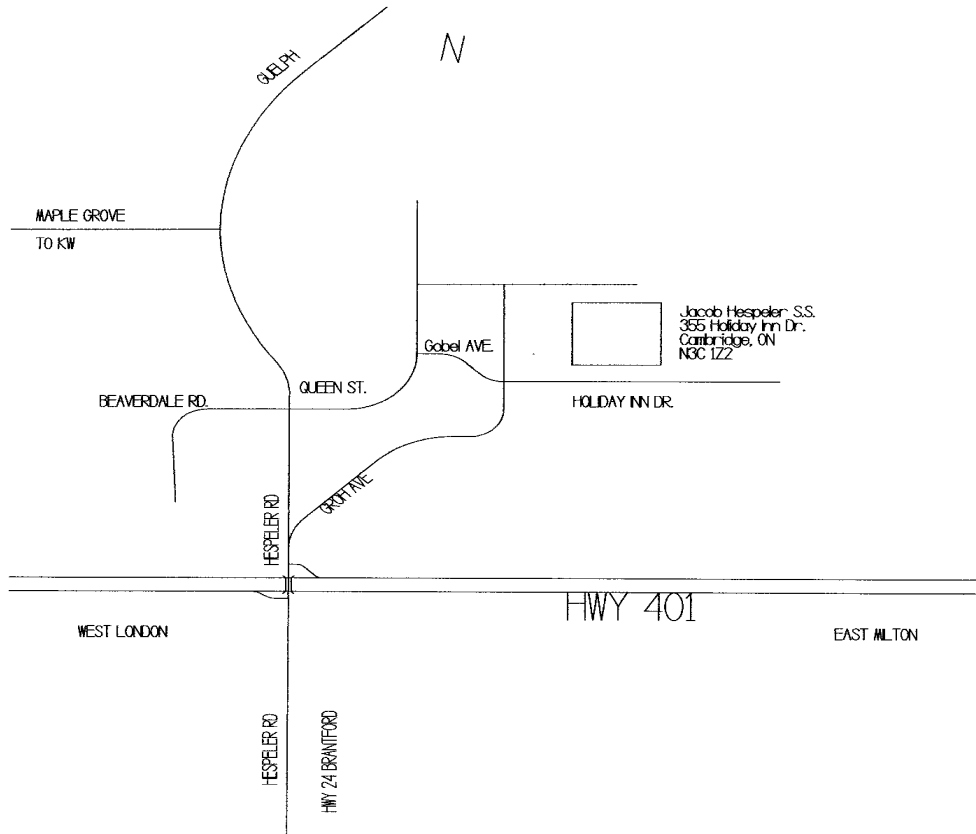

Go to mapquest at www.mapquest.ca to get a map.

April 14th, 2012- Thunder Bay St. Patrick High School
621 S. Selkirk Street, Thunder Bay, ON P7E 1T9
Phone: (807) 623-5218, FAX:(807)622-0164

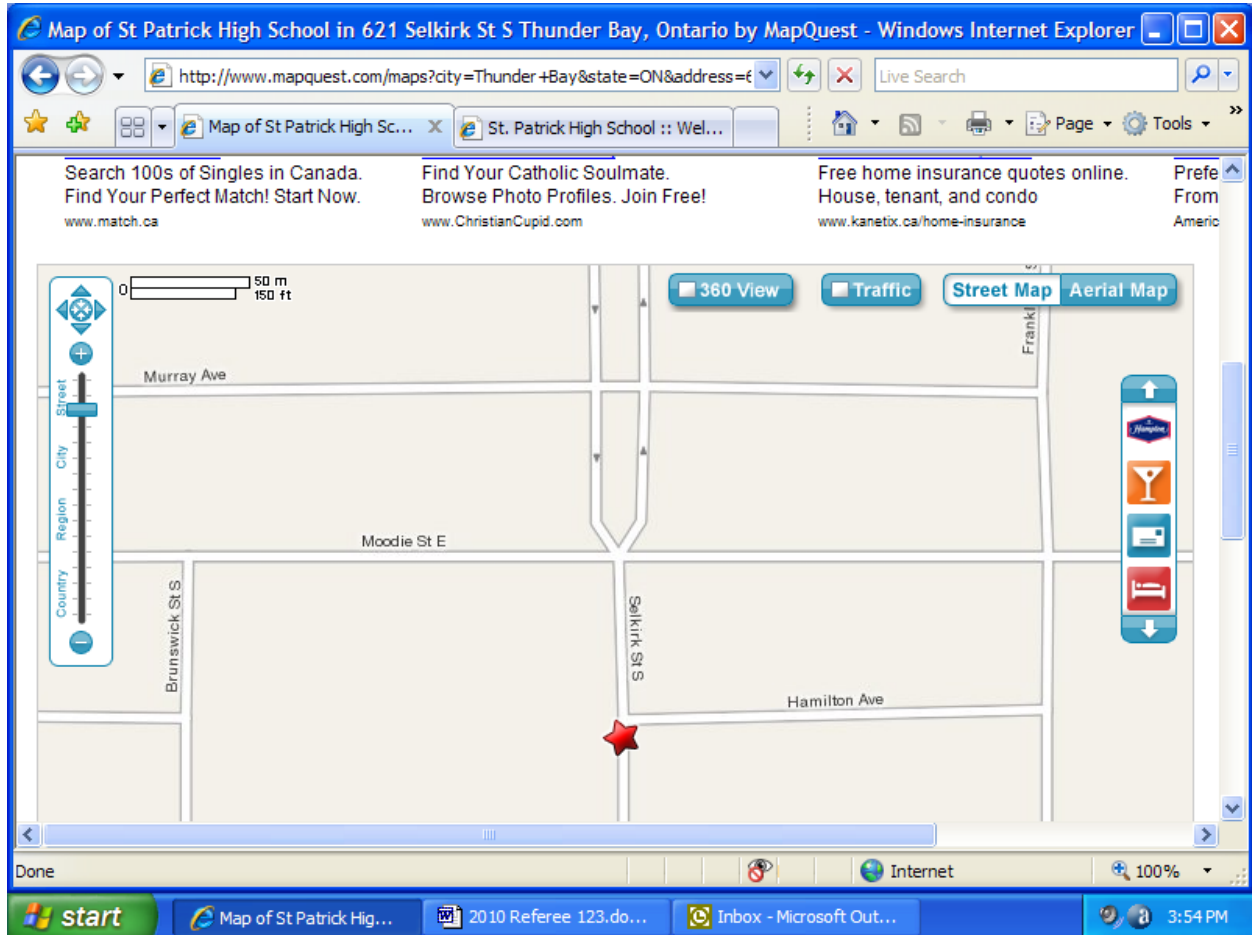

Zone 4
Sunday April 22nd, 2012
Rotary Place (West Orillia Sports Complex)
100 University Ave.
Orillia, ON L3V0B9
705-329-7250

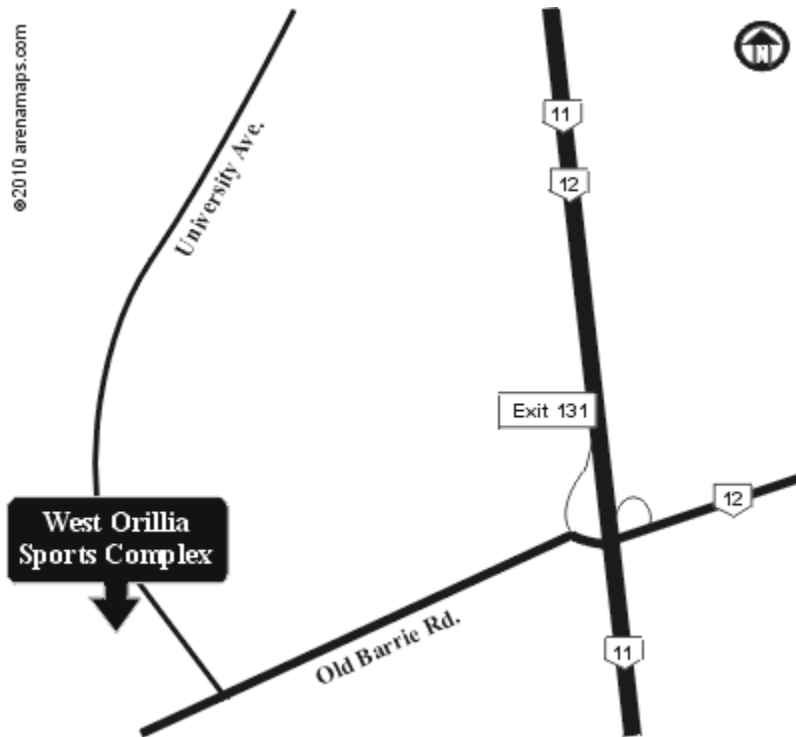

[Click here for Google map of this location](#)

Driving Instructions:

Orillia is located between Lake Couchiching and Lake Simcoe at the intersection of Hwy-11 and Hwy-12 in south central Ontario, approx. 135 km north of Toronto.

From Toronto: Hwy-400 north approx. 83 km to Hwy-11. Proceed north on Hwy-11 approx. 27 km to Old Barrie Rd./Hwy-12 (exit 131B). Proceed west on Old Barrie Rd. approx. 0.25 km to University Boulevard. Turn right on University Blvd. and proceed north a short distance (approx. 0.1 km) to arena on the left.

Zone 10 – Brampton- Turner Fenton High School
Saturday March 24th, 2012

Address: 7935 Kennedy Rd. S. R.R.#10

City: Brampton

Major intersection: Kennedy Road South and Steeles Avenue

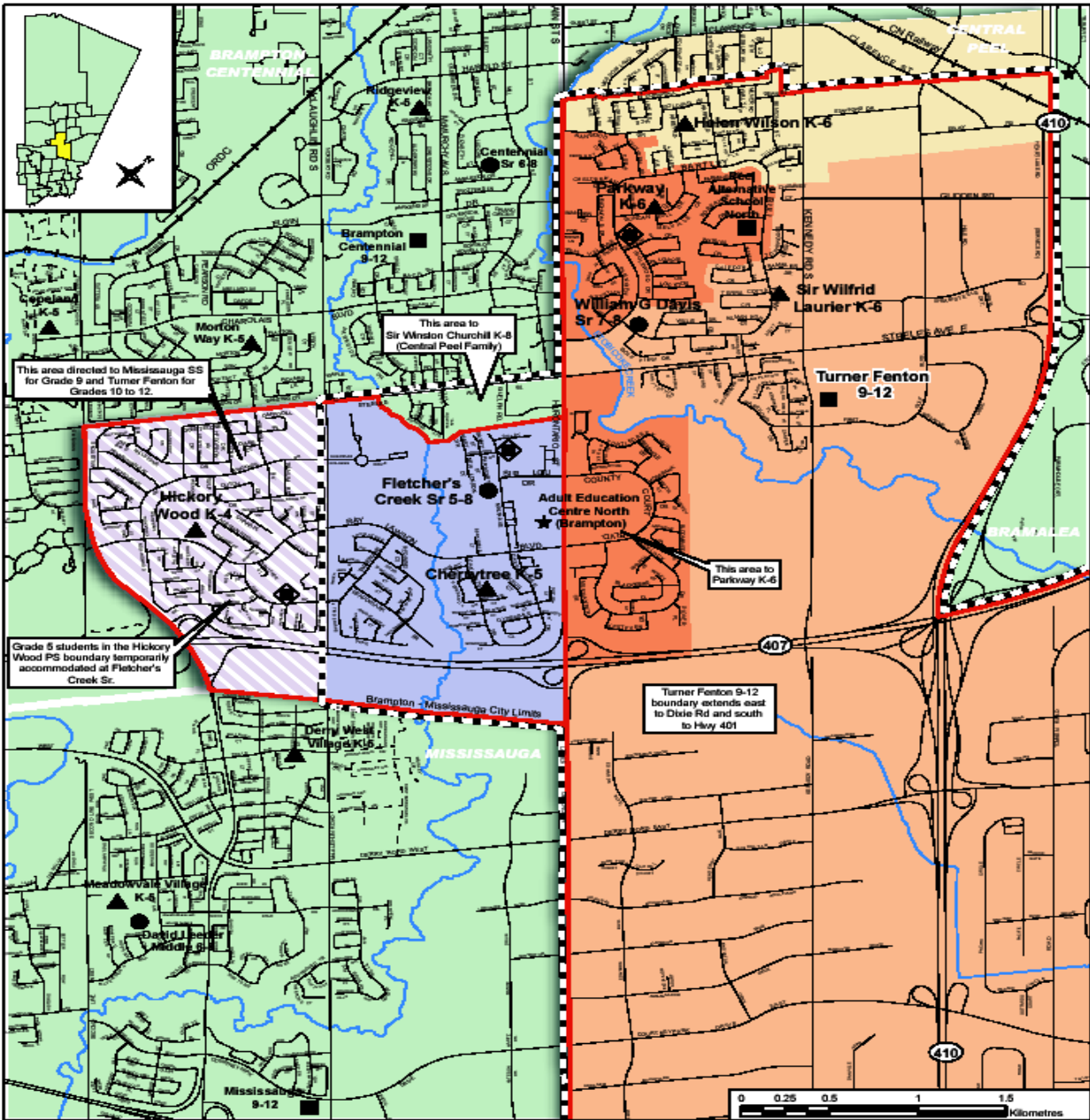

Zone 5-April 22, 2012
Akwesasne Mohawk School
28 AMS Road
Akwesasne, Ontario
(613)-932-3366

Direction 1:

After passing through the Toll Booth you continue south to the crossroads. At the crossroads you will see the Canadian Customs ahead of you [the Seaway International Bridge to the United States of America is behind that], on the left is a little store Jocks hidden behind some shrubbery, on the right is residential. At the crossroads you take a right up a little hill you will see a winding road on the right. Take the winding road up another little hill you will see on the left a clinic and right across on the right is the school. Park in the parking lot and proceed into the school.

Direction 2:

coming from Cornwall, take a right at the main 4way intersection, drive for about 250 yards and take right on Teweseheni Road (it will veer to the left) , go about 400 yards and take right on AMS road, school will be on the right and easy to spot with circular driveway.

